

# INSTALLATION GUIDE

1. Important: During the normal course of installation, you might find some undesirable areas of a board that you may not want in your ceiling or wall (i.e., a knot that might have fallen out, splits, side bent boards, etc.). **DO NOT SET THESE BOARDS ASIDE!** Simply cut out the area on the board you do not want and use the drops as starter or end pieces.

2. To insure a random pattern, start by cutting a random length from a full-length piece or a shorter end-matched board and attach it cut side toward the end wall. We recommend blind nailing. This is done by nailing through the tongue with a finish nail on an angle into solid lumber framing (i.e., bottom of truss, furring strips, etc). The total effective nail penetration through the wood should be at least 1-1/2" deep.

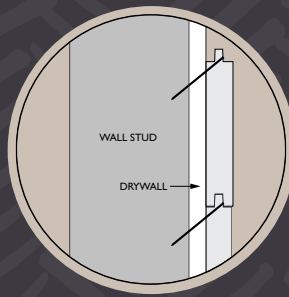

3. Next, attach full length pieces; sliding the end-matched tongues tightly into the grooves, to complete the first run. The end-matched seams do not need to line up on a stud.

4. Use the drop from the first cut to start the second run from the opposite end and complete the run with full length pieces. Save ALL cut offs that have either a male-end or a female-end; these can be used as starter pieces on each run.

5. Plan each run by estimating where you want the next end matched joint to fall.

6. Repeat and continue this process until you are finished covering your surface. Using your mallet/hammer, make sure you keep the joints tight when nailing.

Rustic Seaside 2 3/4" face x 94" long trim boards are available.

## SUGGESTED TOOLS:

- ✓ Tape Measure
- ✓ Blue Tape for Marking / Placement
- ✓ Nail Gun
- ✓ Air Compressor (for nail gun)
- ✓ Rubber Mallet / Hammer
- ✓ Circular Saw / Hand Saw / Jig Saw
- ✓ Nail Set Tool
- ✓ 15 Gauge x 2" Galvanized Nails to Apply Directly to Truss or 2.1/2" Galvanized Nails to Apply Through Drywall into Truss

## ADDITIONAL INFORMATION:

- Do not expose the product to direct sunlight, rain or moisture.
- Because wood is nature's product, when stained, variations in color and grain pattern are to be expected. This is the natural beauty of wood. Color variation and grain pattern (including heartwood) are not considered a defect. Use boards as they come out of the packs. Do not attempt to color match boards in the room.
- For further information on Synergy products, including Board Grading, What to Expect and our 5 Year Limited Warranty, please go to [www.SynergyWood.com](http://www.SynergyWood.com).



3031 S Mellonville Ave      tf: 866.791.6714  
 Sanford, FL 32773            o: 321.397.2000  
 info@synergywood.com      f: 407.679.1108

[WWW.SYNERGYWOOD.COM](http://WWW.SYNERGYWOOD.COM)