



RUSTIC BARNWOOD

INSTALLATION GUIDE

RUSTIC BARNWOOD IS FOR INTERIOR USE ONLY

Due to the variation of Rustic Barnwood plank widths, it is recommended to only work with 2-3 boxes of wood at a time. Unlike traditional wood wall application, Rustic Barnwood requires an artistic, well-thought-out approach to ensure plank placement, as well as seams, are randomized. This will provide an authentic reclaimed look-and-feel, as well as reduce waste. (See back for pattern examples)

1. Important: During the normal course of installation, you might find some undesirable areas of a board that you may not want in your ceiling or wall (i.e., a knot that might have fallen out, splits, side bent boards, etc.). **DO NOT SET THESE BOARDS ASIDE!** Simply cut out the area on the board you do not want and use the drops as starter or end pieces.

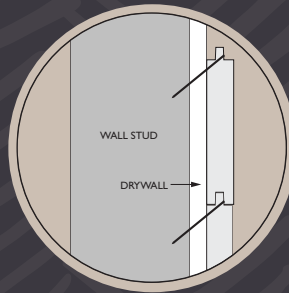

2. To insure a random pattern, start by cutting a random length from a full-length piece or a shorter end-matched board and attach it cut side toward the end wall. We recommend blind nailing. This is done by nailing through the tongue with a finish nail on an angle into solid lumber framing (i.e., bottom of truss, furring strips, etc). The total effective nail penetration through the wood should be at least 1-1/2" deep.

3. Next, attach full length pieces; sliding the end-matched tongues tightly into the grooves, to complete the first run. The end-matched seams do not need to line up on a stud.

4. Use the drop from the first cut to start the second run from the opposite end and complete the run with full length pieces. Save ALL cut offs that have either a male-end or a female-end; these can be used as starter pieces on each run.

5. Plan each run by estimating where you want the next end matched joint to fall.

6. Repeat and continue this process until you are finished covering your surface. Using your mallet/hammer, make sure you keep the joints tight when nailing.

Rustic Barnwood 2 3/4" face x 94" long trim boards are available.

SUGGESTED TOOLS:

- Tape Measure
- Blue Tape for Marking / Placement
- Nail Gun
- Air Compressor (for nail gun)
- Rubber Mallet / Hammer
- Circular Saw / Hand Saw / Jig Saw
- Nail Set Tool
- 15 Gauge x 2" Galvanized Nails to Apply Directly to Truss or 2.1/2" Galvanized Nails to Apply Through Drywall into Truss

ADDITIONAL INFORMATION:

- Do not expose the product to direct sunlight, rain or moisture.
- **This product is designed for interior ceilings and walls ONLY.**
- Because wood is nature's product, when stained, variations in color and grain pattern are to be expected. This is the natural beauty of wood. Color variation and grain pattern (including heartwood) are not considered a defect. Use boards as they come out of the packs. Do not attempt to color match boards in the room.
- For further information on Synergy products, including Board Grading, What to Expect and our 5 Year Limited Warranty, please go to www.SynergyWood.com.



3031 S Mellonville Ave
Sanford, FL 32773
info@synergywood.com

tf: 866.791.6714
o: 321.397.2000
f: 407.679.1108

WWW.SYNERGYWOOD.COM

Have fun creating your own patterns! To achieve a random plank appearance in installation, however, we've included some of our favorite combinations to run the full length of wall or ceiling in your application. These suggestions have been used successfully in other applications but get creative to make your own unique installation! Plank numbers refer to the width of each board. If you plan to use a recommended combination, make sure you plan properly for the required amount of planks to complete a section.

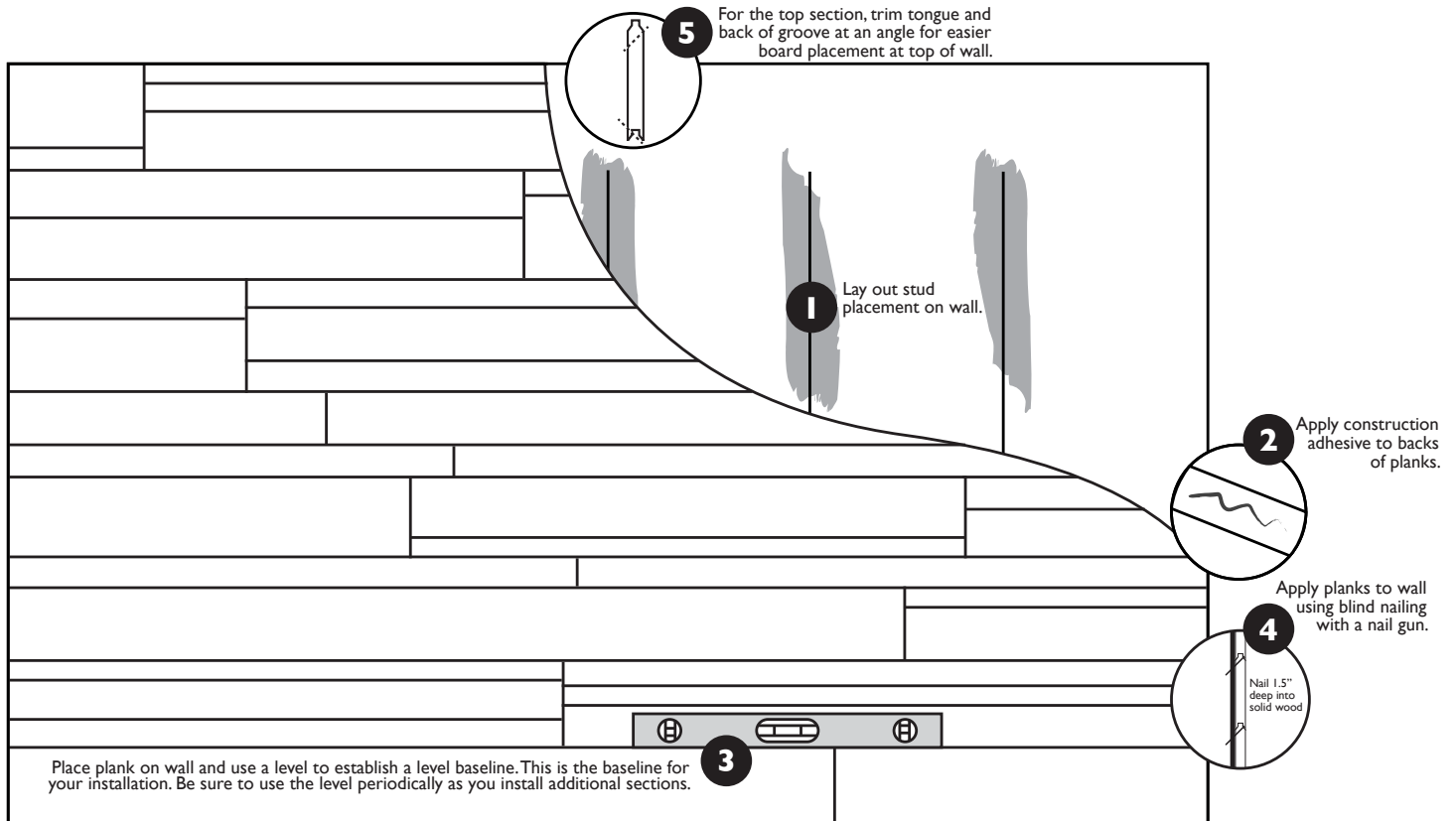
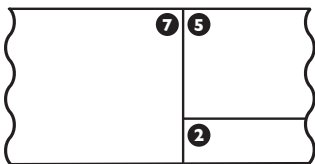

*Diagram is for instructional purposes only. Boards are not to scale.

SAMPLE PLANK COMBINATIONS

Below are some favorite combinations - we encourage you to be creative and find patterns that work for your unique application.

7" RUN



9" RUN

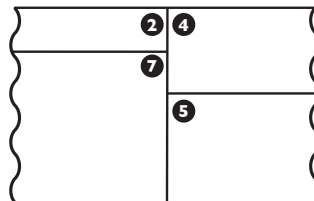

10" RUN

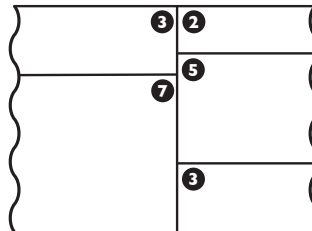

11" RUN

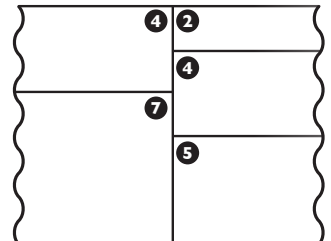

*Diagrams are for informational purposes to serve as recommendation only. Planks are not to scale.

**Please see installation video at www.synergywood.com for detailed steps and information about touch-up.